

Lampiran 2 : Jadwal perawatan *fuel injection pump* di buku manual

Div.	Part to Be Checked	Nature of Service	Checking Servicing Cycle (hrs.)				
			3 mo. or 1,000 ~ 1,500	3 mo. or 2,000 ~ 2,500	1 yr. or 4,000 ~ 5,000	2 ~ 3 yr. or 8,000 ~ 10,000	5 yr. or 16,000 ~ 20,000
Major Moving Parts	Fuel feed pump, lub. oil pump, & cold water pump driving intermediate gear.	Check of tooth bearing & backlash					<input type="radio"/>
		Disassembly, check & measurement of bearing					<input type="radio"/>
		Check of gear mounted shaft tightening force					<input type="radio"/>
Gov. Gear	Governor	Change of hydraulic fluid	*	<input type="radio"/>			
		Disassembly & check				<input type="radio"/>	
Gov. Gear	Governor driving gear	Disassembly & check of tooth bearing & bearing				<input type="radio"/>	
Fuel Oil System	Fuel injection pump	Check of injection timing		<input type="radio"/>			1st time: 300 - 500
		Check of deflector & replacement		<input type="radio"/>			
		Disassembly, cleaning & check		<input type="radio"/>			
	Fuel feed pump	Disassembly & check			<input type="radio"/>		
		Replacement of oil seal			<input type="radio"/>		
F.O.control & stop air piston	Replacement of o-ring				<input type="radio"/>		

Lampiran 3 : Fuel Injection Pump



Plate Page 1 (3)	Fuel Injection Pump	51401-29
---------------------	---------------------	----------

L21/31

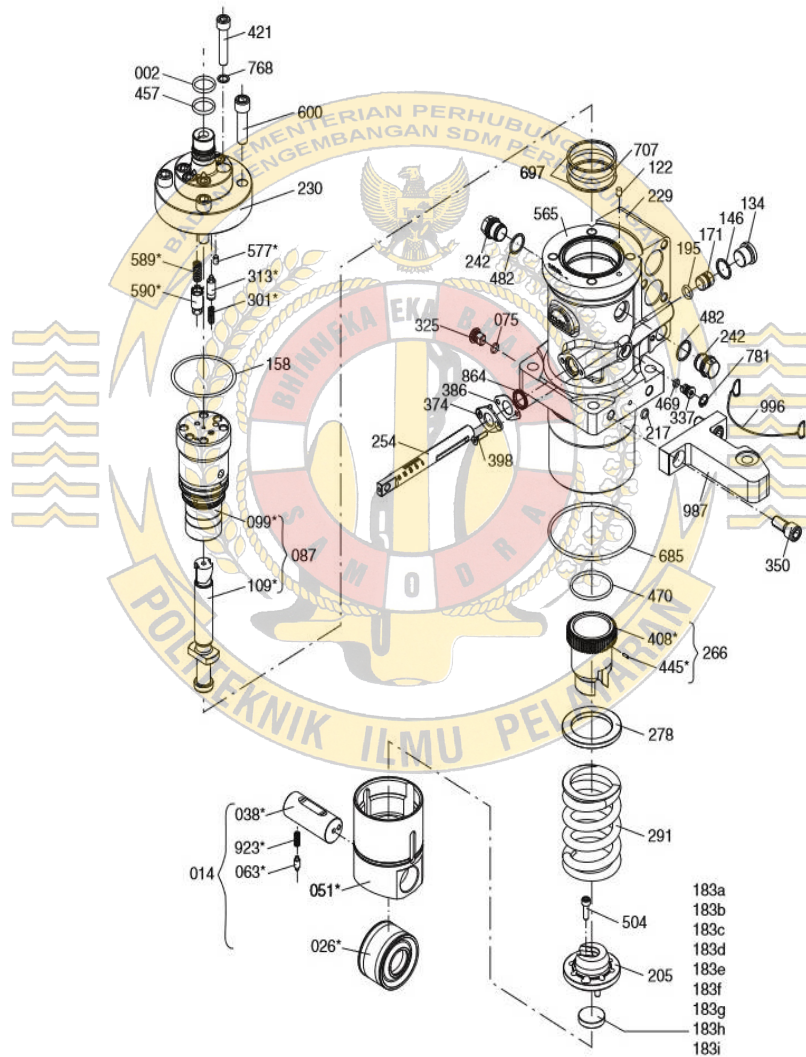

51401-29	Fuel Injection Pump	Plate Page 2 (3)
----------	----------------------------	---------------------

L21/31

Item No	Qty	Designation	Benævnelse	Item No	Qty	Designation	Benævnelse
002	1/P	Seal ring	Tætningsring	266	1/P	Regulating guide complete incl. item 408 and 445	Reguleringsstyr komplet inkl. item 408 og 445
014	1/P	Roller guide complete incl. item 026, 038, 051, 063 and 923	Rullestyr komplet inkl. item 026, 038, 051, 063 og 923	278	1/P	Sping plate	Fjederplade
026*	1/P	Roller	Rulle	291	1/P	Pressure spring	Trykfjeder
038*	1/P	Roller pin	Rulletap	301*	1/P	Pressure spring	Trykfjeder
051*	1/P	Housing	Hus	313*	1/P	Valve cone	Ventilhus
063*	1/P	Bolt	Bolt	325	1/P	Arresting bolt	Bolt
075	1/P	Seal ring	Tætningsring	337	1/P	Arresting bolt	Bolt
087	1/P	Plunger barrel complete incl. item 099 and 109	Pumpe element komplet inkl. item 099 og 109	350	2/P	Socket head cap screw	Umbrakoskrue
099*	1/P	Plunger barrel	Cylinder	374	1/P	Plate	Plade
109*	1/P	Piston	Stempel	386	1/P	Plate	Plade
122	1/P	Cylindrical pin	Cylindrisk stift	398	2/P	Countersunk screw	Skrue
134	1/P	Plug screw	Propskruer	408*	1/P	Regulating guide	Reguleringsstyr
146	1/P	Seal ring	Tætningsring	421	6/P	Screw	Skrue
158	1/P	Seal ring	Tætningsring	445*	1/P	Clamping pin	Stift
171	1/P	Piston	Stempel	457	1/P	Support ring	Støttering
183a	1/P	Shim, 6.90 mm	Skive, 6.90 mm	469	1/P	Seal ring	Tætningsring
183b	1/P	Shim, 6.95 mm	Skive, 6.95 mm	470	1/P	Seal ring	Tætningsring
183c	1/P	Shim, 7.00 mm	Skive, 7.00 mm	482	2/P	Seal ring	Tætningsring
183d	1/P	Shim, 7.05 mm	Skive, 7.05 mm	504	2/P	Screw	Skrue
183e	1/P	Shim, 7.10 mm	Skive, 7.10 mm	565	1/C	Fuel injection pump, complete	Brændselspumpe komplet
183f	1/P	Shim, 7.15 mm	Skive, 7.15 mm	577*	1/P	Cylindrical pin	Cylindrisk stift
183g	1/P	Shim, 7.20 mm	Skive, 7.20 mm	589*	1/P	Pressure spring	Trykfjeder
183h	1/P	Shim, 7.25 mm	Skive, 7.25 mm	590*	1/P	Valve cone	Ventilhus
183i	1/P	Shim, 7.30 mm	Skive, 7.30 mm	600	4/P	Screw	Skrue
195	1/P	Seal ring	Tætningsring	685	1/P	Seal ring	Tætningsring
205	1/P	Spring plate	Fjederplade	697	2/P	Support ring	Støttering
217	1/P	Seal ring	Tætningsring	707	1/P	Seal ring	Tætningsring
229	1/P	Pump housing	Pumpehus	768	6/P	Seal ring	Tætningsring
230	1/P	Connection socket complete incl. item 301, 313, 577, 589 and 590	Forbindelsesstykke komplet inkl. item 301, 313, 577, 589 og 590	781	1/P	Circlip	Snapping
242	2/P	Bolt	Bolt				
254	1/P	Toothed bar	Gevindjern				

When ordering spare parts, see also page 500.50.

Ved bestilling af reservedele, se også side 500.50.

* = Only available as part of a spare parts kit.
Qty/C = Qty/Cylinder
Qty/P = Qty/Pump

* = Kun tilgængelig som en del af et reservedelssæt.
Qty/C = Qty/Cylinder
Qty/P = Qty/Pumpe

Lampiran 4 : Crew List

IMO CREW LIST							
Name of ship :		PAN MARGARET		IMO No.	9545297	Call Sign.	3FFH3
Flag State of Ship		PANAMA					
No.	Family Name, Given Names	Sex M / F	Rank and Nationality	Date and Place Embarkation	Date of Birth	No. of Passport/ Expire date	No. of Seamen's Book/Expire date
1	KIM SOON KWON	M	MASTER KOREA	28-SEP-2015 Beilun, China	25-NOV-1961	BS4003351 29-MAY-2018	BS148-02289 PERMANENT
2	MUHAMMAD YUDI ALFANI	M	C/O INDONESIA	21-OCT-2015 PHE, AU	05-JUN-1981	A 4859637 26-FEB-2018	E 017380 22-SEP-2018
3	YUSWANTO	M	2/O INDONESIA	30-DEC-2015 Zoushan, China	23-SEP-1977	A 6360343 11-SEP-2018	X 001787 02-DEC-2016
4	ARYA NUGRAHA	M	3/O INDONESIA	30-DEC-2015 Zoushan, China	07-MAY-1993	A 5464459 15-MAY-2018	B 067158 03-JUN-2018
5	BAK MU YONG	M	C/E KOREA	04-FEB-2016 Lianyungang, China	16-FEB-1958	BS4000548 23-MAY-2018	BS098-04691 PERMANENT
6	SUGIYARTONO	M	1/E INDONESIA	16-MAR-2016 Bayuquan, China	03-MAR-1974	B 2993526 20-JAN-2021	X 031932 12-APR-2017
7	JERY FERNANDO ZULKARNAIN	M	2/E INDONESIA	16-MAR-2016 Bayuquan, China	10-JUN-1981	A 6537132 30-OCT-2018	D 088018 16-JUN-2018
8	MOCH SUTOWIJOYO	M	3/E INDONESIA	12-NOV-2015 Dangjin, Korea	23-JUN-1992	A 2458582 21-MAR-2017	A 034127 09-APR-2017
9	MAIMAL AMIRUDDIN	M	BSN INDONESIA	21-OCT-2015 PHE, AU	31-DEC-1972	A 7538033 14-FEB-2019	D 073322 22-APR-2018
10	RICO SIMATUPANG	M	AB INDONESIA	21-OCT-2015 PHE, AU	24-FEB-1971	A 8045943 22-APR-2019	B 052512 15-MAR-2018
11	WAHIDUN	M	AB INDONESIA	13-JAN-2016 SINGAPORE	15-APR-1981	B 2402682 20-NOV-2020	E 041241 29-NOV-2018
12	ANNASIANI AMIR	M	AB INDONESIA	16-MAR-2016 Bayuquan, China	25-JUL-1979	A 9246470 16-OCT-2019	D 012437 20-OCT-2017
13	HASAN	M	OS INDONESIA	13-JAN-2016 Singapore	16-FEB-1974	B 0235037 05-JAN-2020	B 069636 16-MAY-2018
14	SUPRIYANTO	M	NO.1 OLR INDONESIA	21-OCT-2015 PHE, AU	21-MAY-1969	B 2071441 18-SEP-2020	A 053116 21-MAR-2018
15	MURWAN BIN MURDIFI	M	OLR INDONESIA	21-OCT-2015 PHE, AU	07-JUL-1971	A 3885195 15-OCT-2017	D 030874 12-DEC-2017
16	IMAM SAFARI	M	OLR INDONESIA	21-OCT-2015 PHE, AU	10-APR-1970	B 2167140 7-OCT-2020	C 050174 17-MAR-2017
17	AKHMAD SAHIT	M	OLR INDONESIA	14-FEB-2016 SINGAPORE	06-SEP-1983	B 2781798 14-DEC-2020	E 039969 30-DEC-2020
18	SYAHRUL SIDIK	M	WIPER INDONESIA	12-NOV-2015 Dangjin, Korea	18-NOV-1983	A 3308912 27-JUN-2017	D 015655 29-OCT-2017
19	YUSUF RAJE	M	C/CK INDONESIA	13-JAN-2016 SINGAPORE	23-NOV-1972	A 4464003 14-JAN-2018	E 034017 19-NOV-2018
20	ACHMAD SYAIFUL	M	CK INDONESIA	12-NOV-2015 Dangjin, Korea	23-SEP-1979	A 6126151 13-AUG-2018	A 025562 13-MAR-2017
21	MOHAMMAD FADEL	M	A/O INDONESIA	14-SEP-2015 Dampier, Au	16-APR-1995	B 1097180 06-MAY-2020	D 072346 22-APR-2018
22	NOVIK IRWANTO	M	A/E INDONESIA	14-SEP-2015 Dampier, Au	30-OCT-1993	B 1496094 02-JUL-2020	D 075245 23-JUN-2018
Signature by Master							
Master : KIM SOON KWON							

Lampiran 6 : Main Particulars

MAN Diesel & Turbo

Description Page 1 (1)	Main Particulars	500.00 Edition 25
---------------------------	-------------------------	-----------------------------

L21/31

Cycle	:	4-stroke
Configuration	:	In-line
Cyl. Nos. available	:	5-6-7-8-9
Power range	:	1000-1980 kW
Speed	:	900/1000 rpm
Bore	:	210 mm
Stroke	:	310 mm
Stroke/bore ratio	:	1.48:1
Piston area per cyl.	:	346 cm ²
Swept volume per cyl.	:	10.7 ltr
Compression ratio	:	16.5:1
Max. combustion pressure	:	210 bar (in combustion chamber)
Turbocharging principle	:	Constant pressure system and intercooling
Fuel quality acceptance	:	HFO (up to 700 cSt@50° C, RMK700) MDO (DMB) - MGO (DMA, DMZ) according ISO8217-2010

Power lay-out		MCR version	
Speed	rpm	900	1000
Mean piston speed	m/sec.	9.3	10.3
Mean effective pressure:			
5 cylinder engine	bar	24.9	22.4
6, 7, 8, 9 cylinder engine	bar	27.3	24.6
Power per cylinder:			
5 cylinder engine	kW/cyl.	200	200
6, 7, 8, 9 cylinder engine	kW/cyl.	220	220

Lampiran 5 : Ship's Particulars

SHIP'S PARTICULARS

SHIP'S NAME	: PAN MARGARET
FLAGS	: PANAMA
PORT OF REGISTRY	: PANAMA
EMAIL ADDRESS	: panmargaret@networkship.com
CLASS	: KOREA REGISTR OF SHIPPING (KR)
OFFICIAL NO	: 44202-PEXT-1
IMO NO	: 9545297
CALL SIGN	: 3FFH3
OWNER	: POS MARITME GB S.A. 53 RD STREET URBANIZACION MARBELLA, MMG TOWER, 16 TH FLOOR, PANAMA REPLUBLIC OF PANAMA
OPERATION	: PANOCEAN CO., LTD
MANAGEMENT COMPANY	: STX MARINE SERVICE CO., LTD.
BUILDER	: STX OFFSHORE & SHIPBUILDING CO LTD. JINHAЕ, REPUBLIC OF KOREA
DATE OF KEEL LAID	: 16 TH DEC. 2011
LAUNCHED DAY	: 02 ND NOV. 2012
DATE OF DELIVERY	: 07 TH FEB. 2013
TYPE OF SHIP	: BULK CARRIER
LENGTH (O.A.)	: 292.00 M
LENGTH (B.P.)	: 283.00 M
BREADTH (MLD.)	: 45.00M
DEPTH (MLD.)	: 24.80 M
FREEBOARD	: 6.617 M
SUMMER LOADED DRAFT	: 18.20 M
SUMMER DISPLACEMENT	: 207,382.90 M/tons

SUMMER DEADWEIGHT	: 180,704.6 M/tons	
LIGHT WEIGHT	: 26,678.3 M/tons	
TPC	: 124.4 MT	
TONNAGE	: <u>INTL' (PANAMA)</u>	<u>SUEZ CANAL</u>
	GROSS 95,047.00 TONNAGE	GROSS 95544.85 TONNAGE
	NET 60,025.00 TONNAGE	NET 90482.93 TONNAGE
MAIN ENGINE	: STX-MAN B&W 6S70MC-C MK7DIESEL ENGINE,	
	WITH FIXED PITCH PROPELLER, 25,320 BHP (MCR)	
HORSE POWER	: 25,013.41 HP (18,660)	
HOLD CAPACITY	: <u>HOLDS'</u>	<u>CAPACITY</u>
	NO. 1 Hold	19,381.8 M3
	NO. 2 Hold	22,829.8 M3
	NO. 3 Hold	22,876.5 M3
	NO. 4 Hold	22,876.5 M3
	NO. 5 Hold	22,876.5 M3
	NO. 6 Hold	22,876.5 M3
	NO. 7 Hold	22,876.4 M3
	NO. 8 Hold	22,539.4 M3
	NO. 9 Hold	20,230.0 M3
	Total:	199,363.5 M3
GMDSS	: DSXC/NBD/VHF MMSI NO.	353267000
	INMARSAT-C TLX. NO.	435326711/435326712
	FAX	870783111982
	TELEPHONE	870773110924

M/V PAN MARGARET

MASTER

Lampiran 7 : Suhu gas buang yang rendah ditunjukkan di monitor

